

# ROTEX® S-H

## Flexible jaw couplings

Flexible jaw and pin & bush couplings

ROTEX®

### Drop-out center design coupling with SPLIT hubs



For legend of pictogram please refer to flapper on the cover

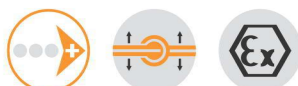

#### Components

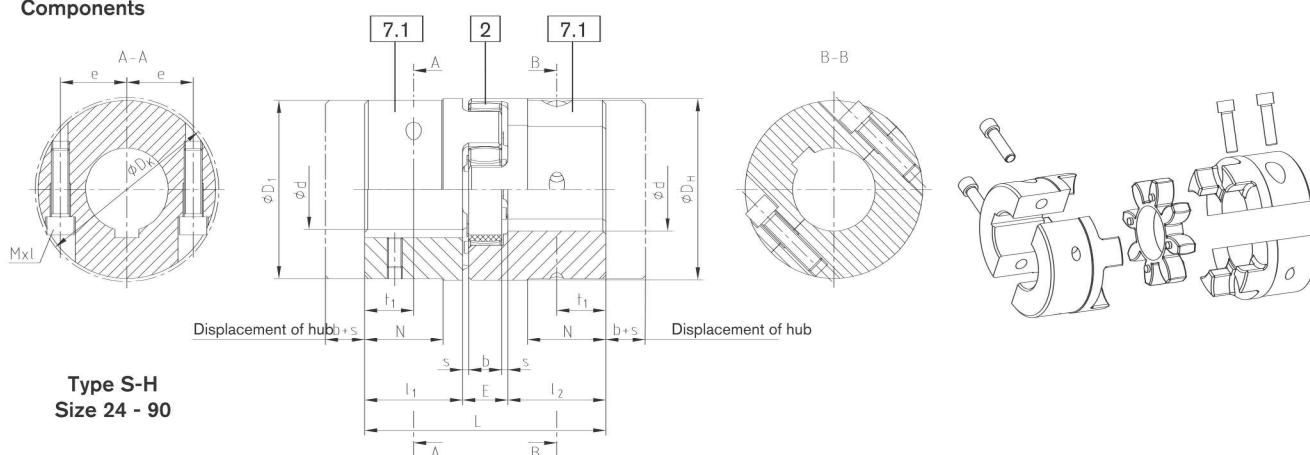

POLY-NORM®

POLY

REVOLEX®

Type S-H  
Size 24 - 90

ROTEX® Type S-H Powder metal steel (Sint)																	
Size	Finish bore d		Dimensions [mm]													Cap screws DIN EN ISO 4762	
	Min.	Max.	L	$l_1, l_2$	E	b	s	D <sub>H</sub>	D <sub>1</sub>	D <sub>K</sub>	N	e	$t_1$	$t_2$	G	Mxl	Tightening torque T <sub>A</sub> [Nm]
24	0	24	78	30	18	14	2	55	-	57.5	-	20	15	10	M5	M6x20	14
28	0	38	90	35	20	15	2.5	65	-	73	-	25	17.5	15	M8	M8x25	34

ROTEX® Type S-H Cast iron (GJL)																		
Size	Finish bore d		Dimensions [mm]													Cap screws DIN EN ISO 4762		
	Min.	Max.	L	$l_1, l_2$	E	b	s	D <sub>H</sub>	D <sub>1</sub>	D <sub>K</sub>	N	e	$t_1$	$t_2$	G	Mxl	Tightening torque T <sub>A</sub> [Nm]	
38	24	45	114	45	24	18	3	80	78	83.5	37	30	22.5	15		M8x30	34	
42	24	55	126	50	26	20	3	95	94	97	40	30	25		M8	M10x35	67	
48	24	60	140	56	28	21	3.5	105	104	108.5	45	35	28			M12x40	115	
55	24	70	160	65	30	22	4	120	118	122	52	40	32.5	20			M12x45	115
65	24	70	185	75	35	26	4.5	135	115	123.5	61	45	37.5		M10	M12x45	115	
	70	80							135	132.5								50
75	40	80	210	85	40	30	5	160	135	147	69	51	42.5	25		M16x50	290	
	80	90							160	158								57
90	40	90	245	100	45	34	5.5	200	160	176	81	60	50	30	M12	M20x60	560	
	90	110							200	197								72

7.1 = SPLIT hub with feather keyway

Ordering example:	ROTEX® 38	S-H	98 ShA	7.1	Ø38	7.1	Ø30
	Coupling size	Type	Spider hardness	Hub design	Finish bore	Hub design	Finish bore